

VTD Series 片式铝电解电容器大尺寸品

Large Size Aluminum Electrolytic Capacitor of V-chip Type

- 寿命: 105°C, 2000 小时
- 适用于回流焊
- 适用于高密度表面组装
- 性能稳定、可靠性高
- Lifetime: 105°C, 2000 hours
- Reflow soldering is available
- Available for high density surface mounting
- High stability and reliability



■ 主要技术性能 Specifications

使用温度范围 Operating Temperature Range	-55~+105°C								
额定电压范围 Rated Voltage Range	6.3~100V DC								
标称电容量允许偏差 Capacitance Tolerance	±20% (120Hz, 20°C)								
漏电流 (20°C) Leakage Current	I ≤ 0.01CV (μA) 或 3 μA 取较大者, (2 分钟)								
	I ≤ 0.01CV (μA) or 3 μA Whichever is greater (after 2 minutes)								
I=Leakage Current(μA), C=Capacitance(μF), V=Rated DC Working Voltage(V)									
损耗角正切值 Dissipation Factor (120Hz 20°C)	WV	6.3	10	16	25	35	50	63	100
	tg δ	0.30	0.22	0.16	0.14	0.12	0.12	0.11	0.10
温度特性 (120Hz) Temperature Characteristics Impedance Ratio (120Hz)	WV	6.3	10	16	25	35	50	63	100
	Z _{-25°C} /Z _{+20°C}	4	3	2	2	2	2	2	2
	Z _{-40°C} /Z _{+20°C}	8	6	4	4	3	3	3	3
耐久性 Load Life	+105°C 施加额定电压 2000 小时, 恢复 16 小时后, 电容器应满足要求 After applying for 2000 hours at +105°C and then resumed 16 hours. the capacitor shall meet the following limits.								
	电容量变化率 Capacitance Change	≤ ±20% 初始测量值 (≤16V: ±25% 初始值) ≤ ±20% of Initial measured value (≤16V: ±25% of the initial value)							
	漏电流值 Leakage	≤ 规定值 ≤ The specified value							
	损耗角正切值 Dissipation Factor	≤ 2 倍规定值 ≤ 200% of the specified value							
高温贮存 Shelf Life (105°C)	试验时间: 1000 小时, 其他项目与耐久性相同。电压应用处理: 根据 JIS C5101-4.1 Test time: 1000 hours; other items are same as the endurance. Voltage application treatment: According to JIS C5101-4 4.1								
额定纹波电流频率系数 Coefficient of Frequency for Rated Ripple Current	Frequency		50Hz	120Hz	1KHz	≥10KHz			
	Rated voltage		0.80	1	1.15	1.25			
	6.3V~16V		0.80	1	1.25	1.40			
	25V~35V		0.80	1	1.35	1.50			
	50V~63V		0.70	1	1.35	1.50			

VTD Series

外形图 Outline Drawing

单位 Unit : mm

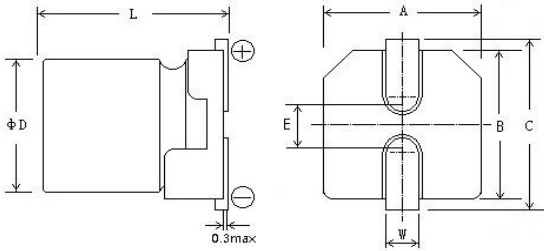

Size	Φ 6.3×7.7	Φ 8×6.2	Φ 8×8	Φ 8×10.2	Φ 10×10.2	Φ 10×12.5
A±0.2	6.6	8.3	8.3	8.3	10.3	10.3
B±0.2	6.6	8.3	8.3	8.3	10.3	10.3
E	2.2	3.1	3.1	3.1	4.5	4.5
L	7.7±0.3	6.2±0.3	8.0±0.3	10.2±0.5	10.2±0.5	12.5±0.5
C±0.2	7.2	9.0	9.0	9.0	11.0	11.0
W	0.5~0.9	0.8~1.1				

VTD Series

标称电容量、额定电压、额定纹波电流与外形尺寸对应表

Nominal capacitance, rated voltage, rated ripple current and case size table

Cap(μF)	6.3V		10V		16V		25V	
	ΦD×L (mm)	I (mA)	ΦD×L (mm)	I (mA)	ΦD×L (mm)	I (mA)	ΦD×L (mm)	I (mA)
100	-	-	-	-	-	-	6.3×7.7 8×6.2	132 146
220	6.3×7.7	135	6.3×7.7 8×6.2	156 173	6.3×7.7 8×6.2	157 183	8×10.2	320
330	6.3×7.7 8×6.2	163 181	8×10.2	296	8×10.2	291	8×10.2	320
470	8×10.2	320	8×10.2	326	8×10.2	348	10×10.2	490
680	8×10.2	340	10×10.2	440	10×10.2	484	-	-
1000	8×10.2 10×10.2	370 495	10×10.2	500	10×10.2	540	-	-
1500	10×10.2	550	-	-	-	-	-	-
Cap(μF)	35V		50V		63V		100V	
	ΦD×L (mm)	I (mA)	ΦD×L (mm)	I (mA)	ΦD×L (mm)	I (mA)	ΦD×L (mm)	I (mA)
4.7	-	-	-	-	-	-	6.3×7.7 8×6.2	35 40
10	-	-	-	-	6.3×7.7	49	6.3×7.7 8×10.2	35 77
22	-	-	-	-	6.3×7.7	58	8×10.2	100
33	-	-	6.3×7.7 8×6.2	82 91	8×10.2	140	10×10.2	150
47	6.3×7.7	85	6.3×7.7 8×6.2	97 108	8×10.2	170	-	-
100	6.3×7.7 8×6.2 8×10.2	142 158 283	8×10.2 10×10.2	230 262	10×10.2	310	-	-
150	8×10.2	293	10×10.2	300	-	-	-	-
220	8×10.2 10×10.2	302 450	10×10.2	375	-	-	-	-
330	10×10.2	450	-	-	-	-	-	-
470	10×10.2 10×12.5	460 500	-	-	-	-	-	-

I~额定纹波电流 Rated ripple current: (mA, 105°C, 120Hz)